

Product Specifications



Project Designation rev1.00

smartLT model : FMPC-300LT

- Features**
- DMX controller dedicated for flicker function. Expressing flickering light such as a candle.
 - 100 scenes programmable by a software, individually allocating a scene to 30 DMX channels.
 - 8 patterns can be called by external input. (dry contact)
 - Program data stored and played on SD card.
 - The software comes with a product with no charge.

Major Spec

Term I	Term II	spec	note
model number	-	FMPC-300LT	smartLT ^(TM)
power	input power	DC24V	power consumption 10W
control	control method	DMX512	
	# of channels	30	
	scenes	100	100 step max. per scene
	patterns	8	
	fading time	0.00 ~ 10.00 sec.	10 msec increment
connectors	input power	M3 terminals, two ports	
	DMX output	M3 terminals, four ports	input & through ports
	external input	dry contact input, eight ports	
	serial port	-	
	USB port	-	
	Ethernet port	RJ45, one port (for program transfer)	10/100BASE
program	editing	by an application software	
	storage	SD memory card / back-up on PC	
	playback	calling a pattern from external input	
operating conditions	peripheral temperature	0 ~ 40 deg. C	
	peripheral humidity	45 ~ 80% (no condensation)	
dimensions	size	H100 x W146 x D65 (mm)	
	weight	490g	

Front View

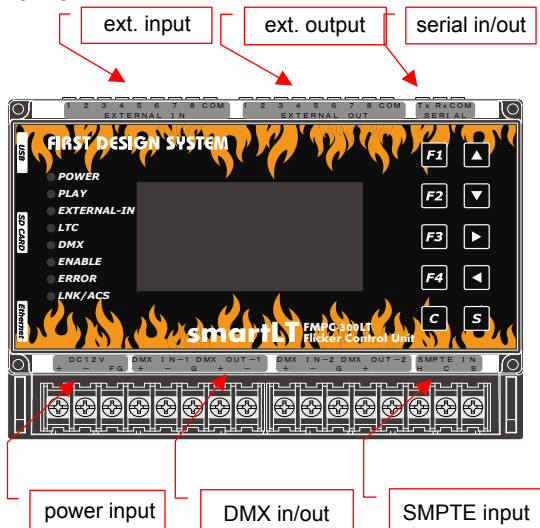

Top View

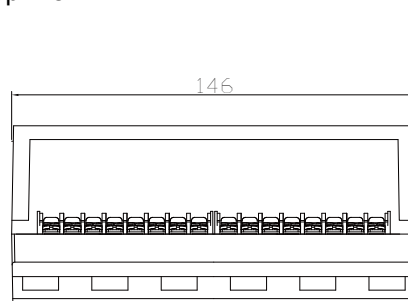

Side View

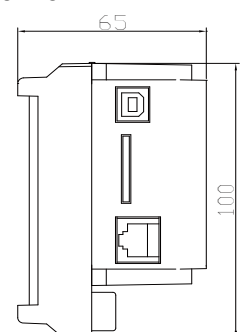

System Diagram

